

Porch Rail Installation Instructions

Thank you for choosing Southern Vinyl Manufacturing, LLC as your porch rail provider. Please read entire instructions before installing your new vinyl porch rail.



If you also purchased stair rails, refer to the Stair Rail Installation Instructions provided with your stair rail kit. These instructions assume that the deck surface is level and that the posts are plumb. These instructions explain how to install porch rail in a typical application. For alternate applications, or for any other vinyl fence and handrail information, visit our website www.svmlc.com.

Always check with your local building code official for regulations specific to your area.

In your porch rail kit box you will find...

- 1 Top rail
- 1 Aluminum top rail insert
- 1 Bottom rail
- 2 Top rail brackets with hardware
- 2 Bottom rail brackets with hardware
- 1 3-piece foot block with hardware
2 foot blocks with 10 feet long porch rail
- Pickets *quantity depends on length*
 - 9 *4 feet long*
 - 13 *6 feet long*
 - 18 *8 feet long*
 - 22 *10 feet long*

Posts, Post Caps and Post Trim Rings are sold separately. Load bearing Columns, Round Column Adaptors, Wall Mounts and other accessories also available.

Step 1.

Install posts and post trim rings. Vinyl posts can be “sleeved” over wood posts or over post mounts made specifically for vinyl posts. Measure the distance between posts. Ensure posts are plumb.

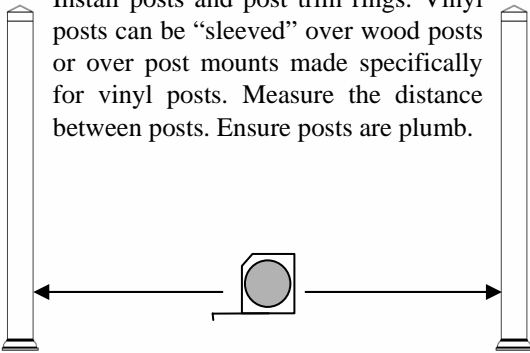

If using post mounts made specifically for vinyl posts, refer to instructions provided with the post mounts.

Step 3.

Attach foot block to the underside of bottom rail. With foot block in the collapsed position, mount it in the center of rail using the supplied screw.

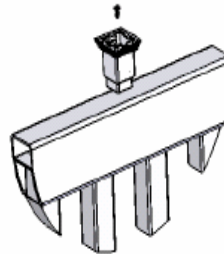

One foot block is supplied for 4, 6 and 8 foot long porch rail. Two foot blocks are supplied for 10 foot long porch rail.

For 10 foot long porch rail, equally space the two foot blocks and attach as described above.

Step 2.

Cut rails to length if necessary. Cut equal amounts from each end of rail to ensure the rail is centered. **DO NOT** cut to length from just one end. The top rail can be cut with aluminum insert inside.

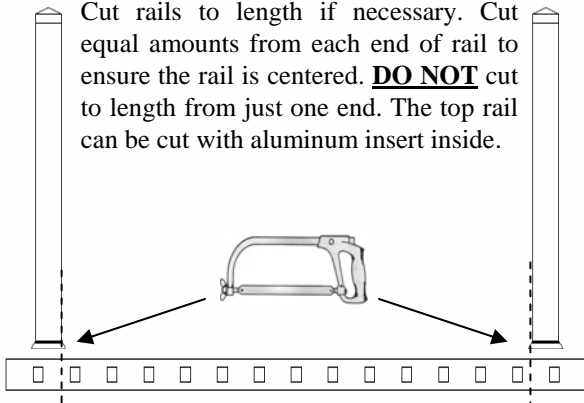

Step 4.

Center the mounting plate on deck surface so that it will be in line with the foot block installed on bottom rail. Screw the mounting plate to deck using the supplied screw.

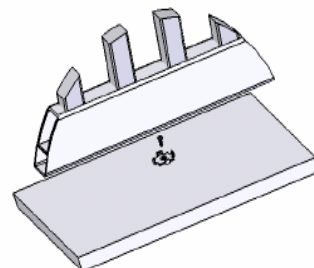

Step 5.

Slide brackets onto bottom rail. Ensure flange or widest part of bracket is facing end of the rail.

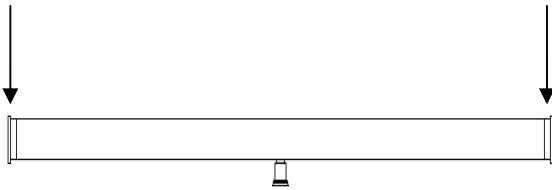

Step 6.

Position bottom rail between posts. Be sure rail is installed level. Check your local building codes to determine the distance between the underside of bottom rail and deck surface.

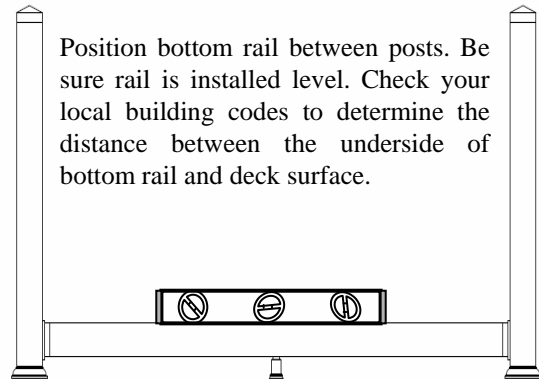

If post trim rings are desired, make sure they are installed over posts prior to attaching bottom rail.

Step 7.

Attach brackets to posts using the #10-32 stainless steel screws provided. Cover the mounting screws with hole plugs supplied.

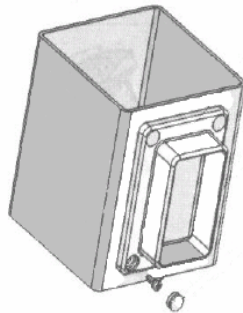

Step 8.

Install supplied stainless steel snap cap screw into side of bracket and through rail. Cover the screw head with snap cap provided.

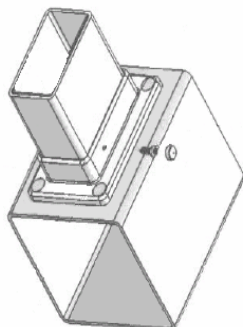

Step 9.

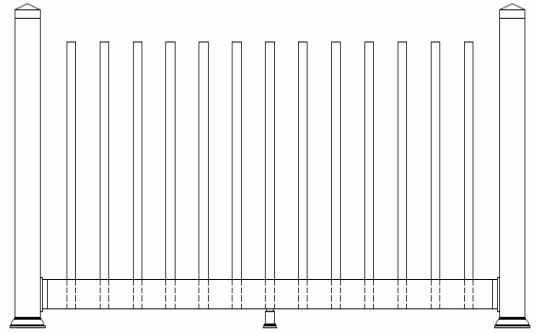

Insert pickets into bottom rail. Ensure pickets insert fully into rail and extend all the way to the bottom. Pickets will insert approximately 3 $\frac{3}{8}$ inches.

Step 10.

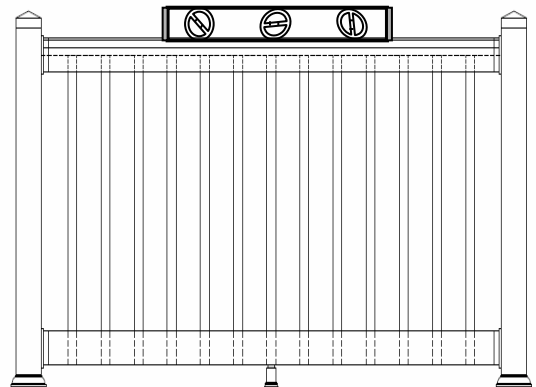

Slide top rail brackets on top rail. Position top rail with aluminum insert onto pickets. Ensure pickets insert fully into rail and extend all the way to aluminum insert (approximately 1 $\frac{3}{4}$ inches). Make sure top rail is level. Attach top rail to posts referring to steps 7 & 8 to attach brackets. Check your local building codes to determine the height of top rail from deck surface.

Step 11.

Pull down foot block over mounting plate until it sits flush with deck surface. Install the supplied set screw and snap cap into side of foot block.

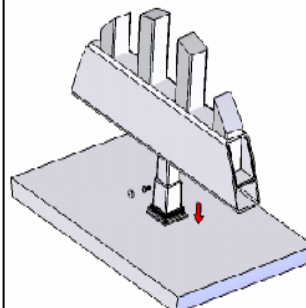

Ensure the set screw is installed through side of both sliding pieces of foot block. The screw is used to "lock" the foot block so it will not return to it's collapsed state. This step is essential for optimum porch railing performance.

Finish your porch rail installation by installing your posts caps on your posts using a PVC rated adhesive.